

# Reopen SMART Reopen SAFE



Updated plan for the Reopening of Diman  
RVTHS  
3-23-2021

Dear Diman Family,

As the Assistant Superintendent-Principal, and on behalf of the School Board and Administration, I am proud of every student, parent, teacher, and staff member for their resilience, adaptability, patience, and fortitude this school year. We have proven that no matter the circumstance or location, high-quality educational excellence will not be denied at Diman. With that being stated, we have also learned that a Diman in-person education cannot be replicated.

Based on the most recent directives from the Department of Education, Diman has been preparing for a full in-person reopening in May. In order to follow a phased-in approach and to acclimate all stakeholders for a full in-person return, Diman will bring back all vocational students on Monday, March 29, based upon their scheduled week for the full two week cycle. In addition, understanding the needs of our freshmen students, grade 9 students will return to academics based on their cohort. We recognize this preliminary report does not answer every question about our first phased reopening. Please know that more details will be provided leading up to March 29. <https://www.dimanregional.org/reopen>

This report details the procedural information for students returning on Monday, March 29. Please be reminded all current student cohorts and learning plans are still in effect. The most recent survey sent was for planning purposes only and not be utilized for our return on March 29.

Students will follow their current learning model. All students, at all grade levels, who are currently hybrid will return for both weeks of their vocational program. All students who are currently hybrid will remain remote for academics, except for freshmen students. Freshman students will return for academics for one week, based on their cohort. For example, Freshmen Cohort B1 will be in-person for academics on Monday, March 29. All other academic cohorts will remain remote. Special cohorts that are in academics currently will continue to follow their same in-person academic schedule. Current remote only students will remain remote. Again, our most recent survey and results do not affect anything at this time.

Diman will continue working with medical experts to ensure the health and safety of students and staff throughout the year. We will continue to follow strict health guidelines - wearing masks, socially distancing, and keeping our buildings clean. The pages that follow will serve as a guide to help navigate the next few weeks together. We are committed to making sure that every child is fully supported, engaged, and safe as we embark on a successful ending to the school year. I remain honored to serve as your Assistant Superintendent-Principal.

Andrew D. Rebello  
Assistant Superintendent-Principal



# Phased Reopening Plan

---

- Monday, March 29:
  - Full return for vocational programs (both cohorts)
    - Cohort A1 & A2 in-person shop (all grade levels) starting Monday, March 29 – April 9.
    - Based on the current learning model, not recent full in-person survey.
    - Current Hybrid students will return for both weeks of shop as opposed to one; current remote students will remain remote.
  - Freshman (hybrid) return to academics based on cohort for one week.
    - Cohort B1: in-person academics for freshmen starting March 29.
    - Freshmen who are remote will remain remote.



# Phased Reopening Plan

---

- Monday, May 3 – May 14: MCAS
- Monday, May 17: Full return in-person: academic and vocational (5 days/week)
  - Use of most recent survey will be in effect starting May 17.
- <https://www.dimanregional.org/reopen>



# Phased Reopening Plan

Cohort A1	
Dates	
March 29, 30, 31, April 1	Shop in person
April 2	No school
April 5, 6, 7, 8, 9	Shop in person
April 12, 13, 14, 15, 16	Gr. 9 Academics in person
April 12, 13, 14, 15, 16	Gr. 10, 11, 12 Academics remote
April 19 — 23	No school
April 26, 27, 28, 29	Gr. 9, 10, 11, 12 Academics remote
April 30	No school
* = Full Remote Learning Day	

Cohort A2	
Dates	
March 29, 30, 31, April 1, April 2	Shop in person
April 2	No school
April 5, 6, 7, 8, 9	Shop in person
April 12, 13, 14, 15, 16	Gr. 9, 10, 11, 12 Academics remote
April 19 — 23	No school
April 26, 27, 28, 29	Gr. 9 Academics in person
April 26, 27, 28, 29	Gr. 10, 11, 12 Academics remote
April 30	No school
* = Full Remote Learning Day	



# Phased Reopening Plan

Cohort B1	
Dates	
March 29, 30, 31, April 1	Gr. 9 Academics in person
March 29, 30, 31, April 1	Gr. 10, 11, 12 Academics remote
April 2	No School
April 5, 6, 7, 8, 9	Gr. 9, 10, 11, 12 Academics remote
April 12, 13, 14, 15, 16	Shop in person
April 19 — 23	No School
April 26, 27, 28, 29	Shop in person
April 30	No School
* = Full Remote Learning Day	

Cohort B2	
Dates	
March 29, 30, 31, April 1,	Gr. 9, 10, 11, 12 Academics remote
April 2	No School
April 5, 6, 7, 8, 9	Gr. 9 Academics in person
April 5, 6, 7, 8, 9	Gr. 10, 11, 12 Academics remote
April 12, 13, 14, 15, 16	Shop in person
April 19 — 23	No School
April 26, 27, 28, 29	Shop in person
April 30	No School
* = Full Remote Learning Day	



## Logistic Data

---

- New morning procedure to accommodate social distancing.
- Based on the current learning model, not full in-person survey.
- Three (3) feet social distance for students:
  - All vocational programs can accommodate.
  - All academic classes can accommodate.
- Six (6) feet social distance for student lunches.



# Arrival & Transportation

---

- Arrival of buses starting at 7:25 a.m. in original spot (Door 24)
- Students will be dismissed, one bus at a time, by an administrator.





# Arrival & Transportation

---

- Student drivers and student drop-off:
  - **Students will NOT be allowed to enter the building prior to 7:25 a.m.**
  - It is recommended to arrive on campus at or after 7:25 a.m.
  - Students who arrive prior to 7:25 a.m. will wait near door 41. Administrators will be assigned to this outside space to ensure mask-wearing and social distancing.
  - Student drivers:
    - Park in the student lot. Student parking lot will be monitored by administrator.
  - Student drop-off:
    - Back to original location: auditorium door (door 41)



# Arrival & Transportation

---

- Use of lockers will not be permitted.
  - Teachers will be asked to not utilize textbooks in school or leave textbooks in the classroom, when possible.
  - CDC guidance: “Books and other paper-based materials are not considered a risk for transmission and do not need additional cleaning procedures”.



# Breakfast

---

- Students will enter through Door 24 (bus) and Door 41 (drivers/drop-off)
  - Door 24: Breakfast in cafeteria (students who ride the bus)
  - Door 41: Breakfast in auditorium (student drivers/drop-off)
  - **Students who are not eating breakfast** will report directly to their first-period academic class or shop.



# Academic Bell Schedule

---

Attendance/late to school bell: 7:45 a.m.

1<sup>st</sup> Period            7:45 a.m. – 8:45 a.m. (8:45 a.m. - 8:55 a.m.: clean + sanitation + transition)

2<sup>nd</sup> Period            9:00 a.m. - 9:55 a.m. (9:45 a.m. - 9:55 a.m.: clean + sanitation + transition)

3<sup>rd</sup> Period            10:00 a.m.- 10:55 a.m. (10:45 a.m. - 10:55 a.m.: clean + sanitation + transition)

4<sup>th</sup> Period            11:00 a.m.- 12:25 p.m. (follow lunch schedule)

5<sup>th</sup> Period            12:30 p.m. - 1:25 p.m. (1:15 p.m. – 1:25 p.m. clean + sanitation + transition)

6<sup>th</sup> Period            1:30 p.m. - 2:28 p.m. (2:15 p.m. – 2:28 p.m. clean + sanitation + dismissal)



# Transition Between Classes

---

- Classrooms will be equipped with more spray bottles and rags.
  - Students will clean their area before leaving the classroom.
  - Hand sanitizer use after holding the bottle.
- Vocational programs will be provided additional bottles and rags.



# Transition Between Classes

---

- In order to control hallway traffic, strict adherence of the one-way directional must be followed.
- Academic classes will not release classes between periods until an announcement is made.
  - Classes will be released based on location of the classroom.
  - Lunch dismissal will also be announced. Students must wait for the announcement to proceed to lunch.

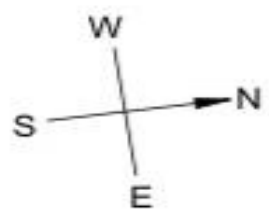

# DIMAN

## REGIONAL VOCATIONAL TECHNICAL HIGH SCHOOL

### FIRST FLOOR WITH EXTERIOR DOORS

- "A" WING
- "D" WING
- "B" WING
- "E" WING
- "C" WING
- OVERHEAD DOOR
- HINGED DOOR

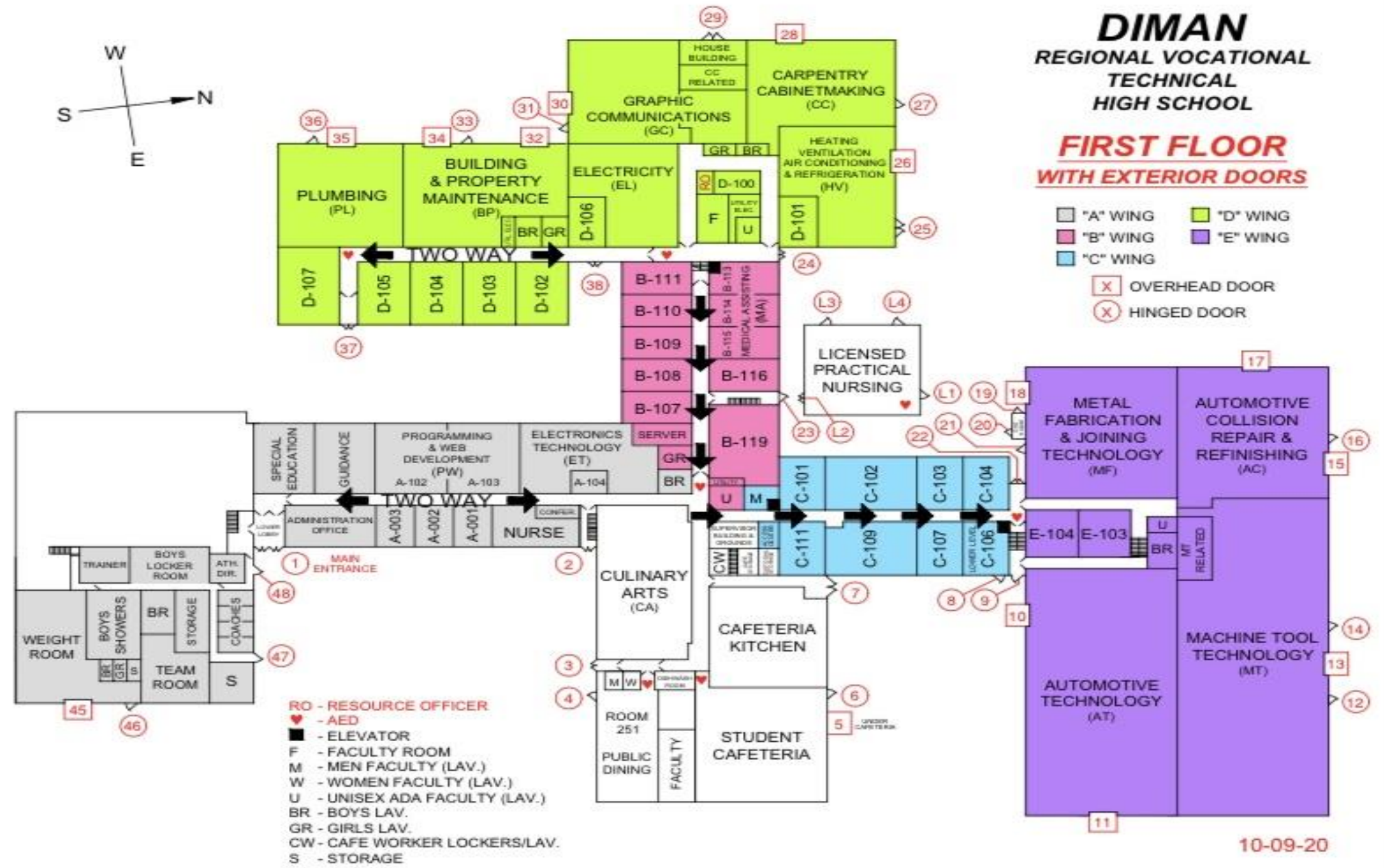

- RO - RESOURCE OFFICER
- ♥ - AED
- - ELEVATOR
- F - FACULTY ROOM
- M - MEN FACULTY (LAV.)
- W - WOMEN FACULTY (LAV.)
- U - UNISEX ADA FACULTY (LAV.)
- BR - BOYS LAV.
- GR - GIRLS LAV.
- CW - CAFE WORKER LOCKERS/LAV.
- S - STORAGE

**DIMAN**  
**REGIONAL VOCATIONAL**  
**TECHNICAL**  
**HIGH SCHOOL**

**SECOND FLOOR**  
**WITH EXTERIOR DOORS**

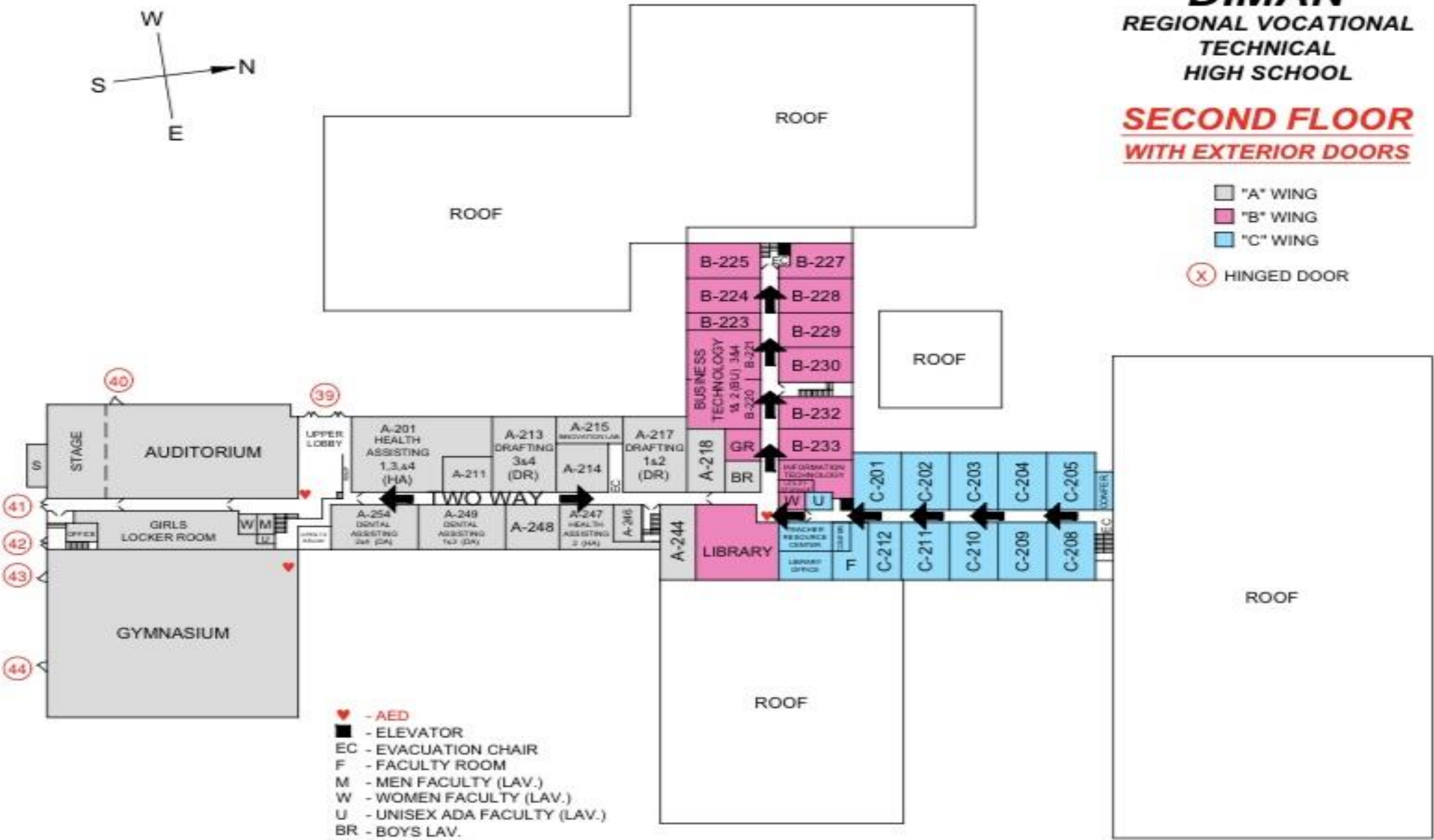
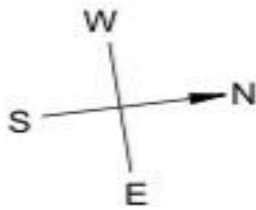

- "A" WING
- "B" WING
- "C" WING
- ⊗ HINGED DOOR

- ♥ - AED
- - ELEVATOR
- EC - EVACUATION CHAIR
- F - FACULTY ROOM
- M - MEN FACULTY (LAV.)
- W - WOMEN FACULTY (LAV.)
- U - UNISEX ADA FACULTY (LAV.)
- BR - BOYS LAV.
- GR - GIRLS LAV.
- S - STORAGE





# Lunch Schedule - Academics

---

## 1<sup>st</sup> lunch (11:00 a.m. - 11:25 a.m.)

PE/HEALTH, A211 to A 218, C201, C212, A244, D101, A104 – Auditorium  
A 244, A 246, A 248, D100, D102, D103, D107 – Cafeteria  
A001, A002, A003 - Gym

## 2<sup>nd</sup> lunch (11:30 a.m. - 11:55 a.m.)

B107, B108, B109, B110, B116 – Auditorium  
B119, C101, C102, C103, C104 - Cafeteria  
C107, C109, C111 – Gym

## 3<sup>rd</sup> lunch (12:00 p.m. - 12:25 p.m.)

2<sup>nd</sup> floor B wing – Auditorium  
C202, C203, C204, C205, C208 – Cafeteria  
C209, C210, C211 - Gym



# Lunch Schedule - Vocational

---

## 4<sup>th</sup> Lunch (12:30 p.m. - 12:55 p.m.)

BP, CC, HVAC – Auditorium (use D-Wing exit: door 37)

AC, ET, PW – Cafeteria

GC, MA - Gym

## 5<sup>th</sup> Lunch (1:00 p.m. - 1:25 p.m.)

DA, HA, DR, PL (exit door 37) - Auditorium

AT, CA, MF, - Cafeteria

BU, AM – Gym

EL – lunch in shop (coverage provided)



# Lunch Expectations

---

- To order lunch, you must complete a Google Form each Sunday for the week. Find the link here:
  - <https://www.dimanregional.org/Page/602>
  - [Lunch Form](#)
- Lunch Procedure:
  - Face forward at all times.
  - Stay in assigned line/seat number.
  - Raise hand to ask for permission to use the bathroom.



# Bathroom Usage

---

- First floor and second floor boys and girls bathrooms will be open.
  - Each bathroom can accommodate four (4) students at one time.
  - If the bathroom is at capacity, students must wait outside the bathroom on a designated marker.
- Diman Staff will utilize paper passes for bathroom permission.



# Student Readiness

---

- After reviewing this plan, submit any questions you have here:
  - [Parent and Student Questions Form](#)
- **Parent and Student Forum: Thursday, March 25, at 6:00 p.m.**
  - Link sent via email.
- Freshmen students will receive a printed copy of the schedule in their first period academic class each week.
  - Students must check their ASPEN account to review their schedule before entering the building.
- Special Academic Cohort Schedule to be emailed directly to parents.



# Student Readiness

---

- Contact your Guidance Counselor:
  - <https://www.dimanregional.org/guidance>
- Contact your Teacher:
  - <https://www.dimanregional.org/Page/836>

# *Diman*

## Tips for Returning to School!



**1. Be SAFE! Practice safe distancing, hand washing, and mask protocols.**



**2. Follow the dress code, including wearing your ID (review the Student Handbook!)**



**3. Your cell phone must be off and out of sight. No cell phone use!**



**4. Visit your Guidance Counselor if you need to talk! Ask your teacher to visit the office.**



**5. Have a question?  
Ask an adult!**



**6. Take a deep breath.  
You got this!**





# Staff Readiness

---

- Faculty and Staff FAQ
- Google Form for questions and feedback
- Virtual Faculty Meeting: Thursday, March 25, 2:30 p.m.
- Staff Survival Kit: Monday, March 29